

Bosch Smart Home

Plug Instruction Manual



BOSCH

Start making your home smart!

Please be sure to install the Bosch Smart Home Controller first.



Please ensure that you have a Bosch Smart Home Controller and the Bosch Smart Home App, and that you have set both of them up successfully.



You can also watch easy to follow installation videos on our website: **www.bosch-smarthome.com/installation**

Set up your product in just three steps



► **Start the Bosch Smart Home App**

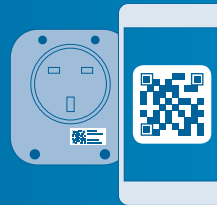

► **Scan the QR code on the underside of the plug or on the enclosed label**

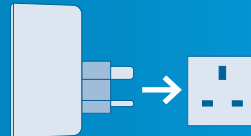

► **Insert the Bosch Smart Home Plug into a socket**



Dear Customer,

Congratulations on purchasing your Bosch Smart Home Plug, it will help to make your home even smarter by connecting electrical appliances to the Bosch Smart Home System.

The Bosch Smart Home Plug allows you to easily control electrical appliances from a coffee machine to a lamp conveniently in or away from your home.

It's easy to install and even enables you to keep an eye on the energy consumption of your electrical appliances.

TABLE OF CONTENTS

1.0 Product description.....08	4.0 The smart plug14	6.0 Connecting to your electrical appliance.....22	8.0 Product details29
1.1 Intended use.....09	4.1 Product overview14	6.1 Connecting instructions.....22	8.1 Technical data.....29
2.0 In the box10	5.0 Set-Up16	6.2 Connecting process27	8.2 Declaration of conformity.....33
3.0 Warning notices12	5.1 Adding to your smart home17	7.0 Maintenance and care28	8.3 Faults in radio operation.....34
3.1 Explanation of symbols12	5.2 Connecting to your smart home18		8.4 Open-source software35
3.2 Safety instructions13	5.3 Configuring the device20		8.5 Environmental protection and disposal38
			9.0 Further information39

1.0 PRODUCT DESCRIPTION

The plug enables you to automatically switch appliances on and off according to a programmable on and off function. It also measures the energy consumption of the connected devices (e.g. fridge).

Quick to install, the plug is ready to use once it has been inserted into a socket and configured in the app. Its compact design means that surrounding sockets are not blocked off.

1.1 Intended use

In order to function properly, the product must be used together with the Bosch Smart Home Controller.

- ▶ Follow the safety instructions and the directions in this manual and the Bosch Smart Home App to ensure that the product is set up correctly.

- ▶ Please note the details in the Technical Data section (see p. 28).
- ▶ Avoid installing in areas prone to high amounts of dust, direct sunshine or heat.



Please take the Technical Data (in particular the maximum permissible switching capacity of the relay and the type of load to be connected) into account before connecting a load! All load data relates to resistive loads!

2.0 IN THE BOX

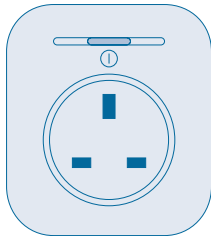

Plug



To operate the plug you will require the app, a controller and an internet connection.

3.0 WARNING NOTICES

3.1 Explanation of symbols



Warning.

This alerts you to danger.



Info.

Indicates important information.

3.2 Safety instructions



Risk of injury even to the point of death from electric shock!

Touching live electrical parts can lead to electric shock.

- ▶ Do not open the product.
- ▶ Do not use the product if has visible signs of damage (e.g. on the housing or on the controls).
- ▶ If you discover a fault, please contact our service team on 00800 8437 6278.

4.0 THE SMART PLUG

4.1 Product overview

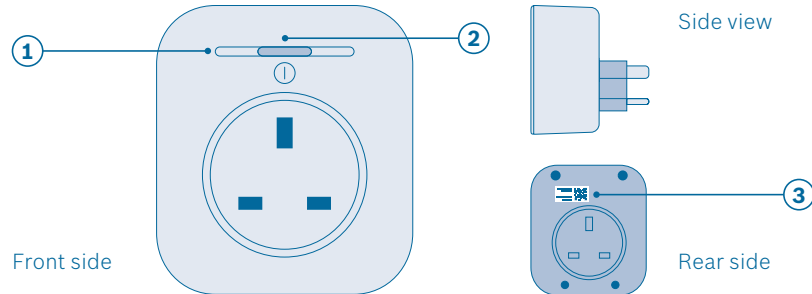

Item	Part	Explanation
1	LED	Indicator for status or fault
2	System button	Confirmation button
3	QR code	Scan for device identification

LED state	Explanation
Red	Fault – please contact our service team on 00800 8437 6278
Orange	Process or update is being performed
Green	Status “on”; Process or update has been completed successfully

5.0 SET-UP



Before you start

Please ensure that you have a Bosch Smart Home Controller and the Bosch Smart Home App, and that you have set both of them up successfully.



You can also watch easy to follow installation videos on our website:
www.bosch-smarthome.com/

5.1 Adding to your smart home

Start the Bosch Smart Home App and select “Add device”.



From this point, the app guides you through the installation process. You will find a brief description in the following pages of this instruction manual.



5.2 Connecting to your smart home

The app will prompt you to scan the QR code on the product. You will find the QR code on the rear of the plug and as a label in the box.

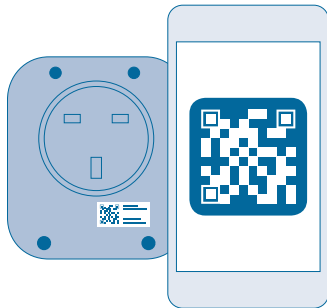

From this point, the app guides you through the installation process. You will find a brief description in the following pages of this instruction manual.

5.3 Configuring the device

Scanning the QR code from within the app starts the configuration process.

The plug's LED indicates the status of the configuration attempt using the following flash codes:

LED state	Explanation
Flashes green once	Successful configuration
Flashes orange	Unsuccessful configuration



If the device is not able to establish a connection to the controller within 3 minutes, the configuration mode is ended. To start the configuration mode again, please press the system button on the plug.

The app will also inform you if the configuration was successful.

6.0 CONNECTING TO YOUR ELECTRICAL APPLIANCE

6.1 Connecting instructions



Risk of injury even to the point of death from electric shock!

Touching live electrical parts can lead to electric shock.

- ▶ Do not open the product.
- ▶ Do not use the product if has visible signs of damage (e.g. on the housing or on the controls).
- ▶ If you discover a fault, please contact our service team on 00800 8437 6278.



Prevailing regulations must be observed when connecting the product. Failure to comply with the regulations can lead to material damage and/or physical injury even to the point of death.



Please take the Technical Data (in particular the maximum permissible switching capacity of the relay and the type of load to be connected) into account before connecting a load! All load data relates to resistive loads! Do not exceed the capacity specified for the device. Exceeding this capacity could lead to the destruction of the device, to a fire or to an electrical accident. The reliable switching off of the connected device is not guaranteed anymore.



Ensure the smart plug is not damaged do not plug into socket if the casing is damaged in any way.

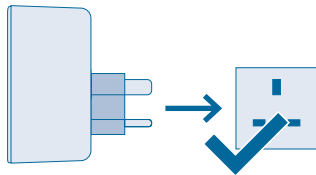

- ▶ Connect the plug to an accessible, grounded wall socket. In the event of danger, pull the device out of the mains socket.

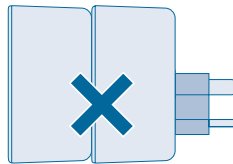

- ▶ Do not insert plugs in a row.

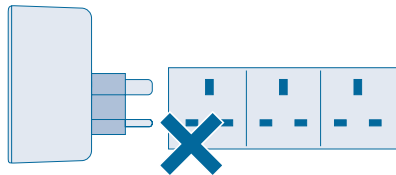

- ▶ Do not use plugs in multiple socket outlets or with extension leads.

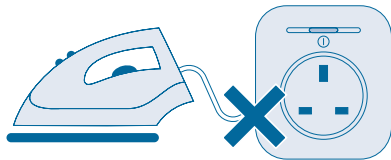

- ▶ Do not connect any appliances which could cause fire or other damage if switched on inadvertently (e.g. irons).

- ▶ Do not use plugs to disconnect appliances from the mains. The load is not galvanically isolated from the mains.
- ▶ Devices with electronic power supply units (e.g. TV or high voltage LED light sources) are no ohmic loads. They can generate inrush currents with more than 100 A. Switching such kind of loads may lead to premature wear of the actuator. In consequence the reliable switching off of the connected device is not guaranteed anymore.

6.2 Connecting process

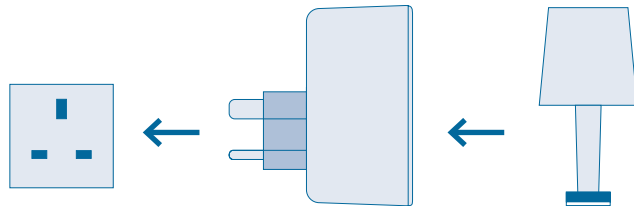

Insert the plug into the socket.
The plug is now ready to use.

You can now plug in the required
electrical appliance.

7.0 MAINTENANCE AND CARE

The product is maintenance-free. Repairs should only be performed by qualified persons. Clean the product with a soft clean dry and lint-free cloth. Do not use cleaning agents containing solvents.



Incorrect handling (see notes on intended use) or non-observance of hazard warnings may compromise the protection afforded by the device.

8.0 PRODUCT DETAILS

8.1 Technical data

Device type name	Plug AA UK
Supply voltage	230 V/50 Hz
Current consumption	16 A max.
Type of protection	IP20
Ambient temperature	-10 °C to +35 °C
Power consumption in standby	< 0.3 W

Max. switching power	3680 W
Load type	Ohmic load, $\cos\varphi \geq 0.95$
Measuring category	CAT II ¹⁾
Relay	Normally open, 1-pole, μ -contact
Switching cycles	40,000 (16 A, ohmic load)
Switch type	Independently mounted switch

¹⁾ Measuring range: 0 to 3680 W; Resolution: 0.01 W; Accuracy: 1% +/-0.03 W (Frequency range 2 Hz to 2 kHz)

Operating type	S1
Withstand voltage	2500 V
Protection class	I
Method of operation	Type 1
Degree of pollution	2
Radio frequency	868,3 MHz/869,525 MHz

Radio range in free-field conditions	> 100 m
Max. transmitting capacity	10 dBm
Receiver category	SRD category 2
Duty cycle	< 1 % per h / < 10 % per h
Software class	Class A
Dimensions (W x H x D)	70 mm x 79 mm x 39 mm (without mains plug)
Weight	155 g

8.2 Declaration of conformity

Hereby, Robert Bosch Smart Home GmbH declares that the radio equipment type Bosch Smart Home Plug is in compliance with Directive 2014/53/EU.

The full text of the EU declaration of conformity is available at the following internet address:

**[www.bosch-smarthome.com/
EU-declarations-of-conformity](http://www.bosch-smarthome.com/EU-declarations-of-conformity)**



8.3 Faults in radio operation

Faults in radio operation (e.g. due to electric motors or defective electrical devices) cannot be ruled out. The radio range inside buildings may differ greatly from the radio range in free-field conditions.

Apart from the transmission power and the receiver characteristics, environmental influences such as humidity and structural characteristics may also influence radio operation.

8.4 Open-source software

This Bosch Smart Home product uses open-source software. You will find the license information for the components used on the opposite side.

core_cm3.h

Copyright (C) 2009-2013 ARM Limited. All rights reserved. Redistribution and use in source and binary forms, with or without modification, are permitted provided that the following conditions are met:

- ▶ Redistributions of source code must retain the above copyright notice, this list of conditions and the following disclaimer.
- ▶ Redistributions in binary form must reproduce the above copyright notice, this list of conditions and the following disclaimer in the documentation and/or other materials provided with the distribution.
- ▶ Neither the name of ARM nor the names of its contributors may be used to endorse or promote products derived from this software without specific prior written permission.

THIS SOFTWARE IS PROVIDED BY THE COPYRIGHT HOLDERS AND CONTRIBUTORS „AS IS“ AND ANY EXPRESS OR IMPLIED WARRANTIES, INCLUDING, BUT NOT LIMITED TO, THE IMPLIED WARRANTIES OF MERCHANTABILITY AND FITNESS FOR A PARTICULAR PURPOSE ARE DISCLAIMED. IN NO EVENT SHALL THE COPYRIGHT OWNER OR CONTRIBUTORS BE LIABLE FOR ANY DIRECT, INDIRECT, INCIDENTAL, SPECIAL, EXEMPLARY, OR CONSEQUENTIAL DAMAGES (INCLUDING, BUT NOT LIMITED TO, PROCUREMENT OF SUBSTITUTE GOODS OR SERVICES; LOSS OF USE, DATA, OR PROFITS; OR BUSINESS INTERRUPTION) HOWEVER CAUSED AND ON ANY THEORY OF LIABILITY, WHETHER IN CONTRACT, STRICT LIABILITY, OR TORT (INCLUDING NEGLIGENCE OR OTHERWISE) ARISING IN ANY WAY OUT OF THE USE OF THIS SOFTWARE, EVEN IF ADVISED OF THE POSSIBILITY OF SUCH DAMAGE.

8.5 Environmental protection and disposal

Electrical and electronic equipment that is no longer usable and defective or used batteries must be separated from other waste and recycled in an environmentally friendly manner (European Directive on waste electrical and electronic equipment).

To dispose of electrical and electronic equipment or batteries, use your country-specific return and collection systems.



9.0 FURTHER INFORMATION

You can find more detailed information on operating and maintaining the plug in the online FAQs at **www.bosch-smarthome.com/faq**

You will also find all contact details on the rear side of this document.



Sale and transfer

Before you transfer or sell your device, delete your personal information. To do this, reset the device to its factory settings (see online FAQs).



#BeSmarter

INTERCONNECTED SMART HOME PRODUCTS

Save on heating costs, protect your valuables, create mood lighting and much more: Bosch Smart Home offers a complete, intelligent system to make your life more comfortable, safer and more sustainable.

More at www.bosch-smarthome.com



Radiator Thermostat



Door/Window Contact



Smoke Detector



🏠 Robert Bosch Smart Home GmbH
Schockenriedstraße 17
70565 Stuttgart, Germany

☎ 00800 8437 6278 (free)
Mon–Fri 7:00 am–8:00 pm
Sat 8:00 am–6:00 pm

✉ service@bosch-smarthome.com



BOSCH