

Bosch Smart Home

Eyes-Outdoor Camera Instruction Manual

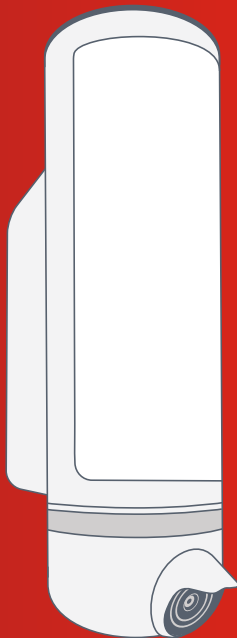

BOSCH

Start making your home smart!



You need the Bosch Smart Camera App to install, configure and use your Bosch Smart Home Eyes-Outdoor Camera. Please also make sure that you have a stable Wi-fi internet connection available at the installation location.



Make sure that you download the Bosch Smart Camera App first!

Set up your Eyes-Outdoor Camera in just three steps



► **Start the Bosch Smart Camera App**



► **Mount the Eyes-Outdoor Camera and power it up**

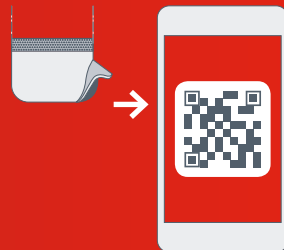

► **Use the Bosch Smart Camera App to connect and configure your Eyes-Outdoor Camera**



You can also watch easy to follow installation videos on our website:
www.bosch-smarthome.com/installation



Dear Customer,

Congratulations with the purchase of your Bosch Smart Home Eyes-Outdoor Camera. It will help you to make your home more secure and smarter. Integrated motion sensors automatically detect motion and record events, while the built-in lights ensure high quality images at night and offer an attractive illumination to the exterior of your home. With the Bosch Smart Camera App you can access the recordings and live images from anywhere, so you will always know if everything is in order around your home.

**We hope you enjoy your new product,
The Bosch Smart Home Team**

INDEX

1.0 Product overview	08	4.0 Indicators and control	16	6.0 Installation and initial configuration	28	10.0 Product details	35
1.1 Target application	09	4.1 Product overview	16	6.1 Start Camera App	21	10.1 Technical details.....	35
2.0 In the box	10	5.0 Fixing	20	6.2 Add Eyes-Outdoor Camera to network	22	10.2 Declaration of conformity.....	36
3.0 Warning notices	12	5.1 Fixing instructions.....	20	7.0 Error and error resolutions	32	10.3 Faults in radio operation.....	36
3.1 Safety message explanation	12	5.2 Check the Wi-fi availability	21	8.0 Eyes-Outdoor Camera operation	33	10.4 FCC Statement.....	37
3.2 Legal notice.....	13	5.3 Install the mounting plate.....	22	9.0 Maintenance and care	34	10.5 Open-Source-Software	38
3.3 Safety precautions	14	5.4 Power connection	25			10.6 Environmental protection and product disposal	39
		5.5 Place the Eyes-Outdoor Camera.....	26			11.0 Further informations	40
						11.1 Bosch Smart Home System.....	40

1.0 PRODUCT OVERVIEW

Bosch Smart Home Eyes-Outdoor Camera is controlled via Wi-fi and has the following features:

- ▶ Full HD quality video recording
- ▶ Internal memory stores capable of storing up to 200 events
- ▶ Manually adjustable viewing direction
- ▶ Configurable privacy masking
- ▶ Selectable event detection sensitivity
- ▶ Configurable motion sensitive zones
- ▶ LED front light (dimnable)
- ▶ Decorative top/bottom lights
- ▶ Lamps scheduled based on time or on ambient illumination
- ▶ Microphone and speaker for two-way communication

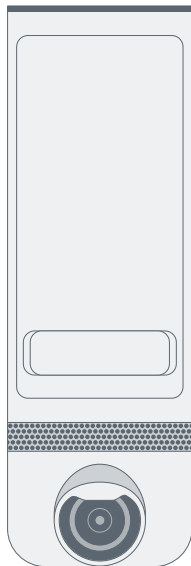

Detailed information on advanced set-up, including sharing access to your camera with friends, can be found at **www.bosch-smarthome.com**

1.1 Target application

The product must only be used together with original Bosch Smart Home components, and is for outdoor use only.

- ▶ Please make sure you strictly follow the safety and installation instructions in this document as well as in the Bosch Smart Camera App
- ▶ Only use the Eyes-Outdoor Camera according the installation instructions and within the temperature and humidity limits as described in the Technical Data section (see p. 35)
- ▶ Avoid direct sun light and sources of heat and cold



Do not open or modify the product in any way. Any other use is considered unintended use. We will not assume liability for any resulting damage.

2.0 IN THE BOX

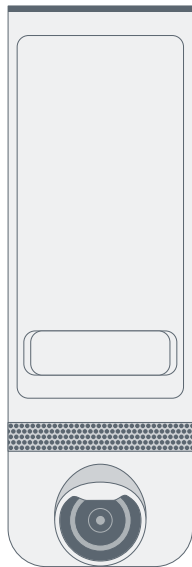

Eyes-Outdoor Camera

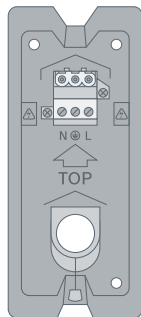

Wall mounting plate

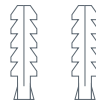

2 wall plugs

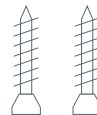

2 mounting screws



Screwdriver

3.0 WARNING NOTICES

3.1 Safety message explanation



Caution!

Indicates a hazardous situation which, if not avoided, could result in minor or moderate injury.



Notice!

Indicates a situation which, if not avoided, could result to damage of the equipment or environment, or data loss.

3.2 Legal notice



Privacy

The Bosch Smart Home Eyes-Outdoor Camera has been developed for use outdoors. You are responsible for ensuring that the camera and related services are used lawfully and in compliance with the statutory requirements applicable at the place of use. In particular, laws in your country may stipulate permissible purposes of use, installation locations, selection of image details and the storage period of the video sequences. If required, inform all persons, employees or third parties who live in the monitored premises and areas or who are present there for a significant period of time of the specific circumstances and the use of the visual security solution in an appropriate manner and obtain any consent that may be necessary.



Security

By using the Bosch Smart Home Eyes-Outdoor Camera you agree not to rely on the device and its services for life safety or critical purposes. Mobile notifications are provided for informational purposes only. Bosch Smart Home GmbH cannot be held liable for missing or incorrect notifications or event registrations.

3.3 Safety precautions



Do not open the Eyes-Outdoor Camera. The Eyes-Outdoor Camera does not contain any user replaceable parts. If the Eyes-Outdoor Camera stops working please contact customer service via telephone 00800 843 762 78. Please adhere to manual instructions on intended use.



Please only use original parts. Please only use the mounting material recommended in this manual. Please do not paint the Eyes-Outdoor Camera.



Caution, risk of electric shock

Please do not open the housing of the Eyes-Outdoor Camera. It contains live parts with the risk of electric shock. Replacing lights is not possible.



This product must only be installed by people legally qualified to install 230V devices. Please check your local legislation in case of doubts.



US/Canada installation

Installations and servicing must be done by qualified technicians and comply with:

- ▶ Installed per the American National Electrical Code (NEC), article 280, or Canadian Electric Code (CEC) guidelines as applicable. The conducting voltage of the surge protector device (SPD) or surge arrester must be less than 2,500 Vpk
- ▶ The branch circuit socket-outlet or circuit breaker shall be installed near the equipment and shall be easily accessible
- ▶ The equipment is designed only for normal building installations (110 VAC 60 Hz)
- ▶ Use an appropriate 16-AWG power cord for this device. Use UL-listed flexible cord, SJ or SO serviceable or better, labeled with the suffix “W,” “W-A,” “Water-Resistant,” or “Outdoor” marked on the cord. Do not allow anything to rest on the power cord and do not install the product where someone can walk on the power cord
- ▶ Do not perform installation activities during thunder storms or when the threat of lightning is present

4.0 INDICATORS AND CONTROL

4.1 Product overview

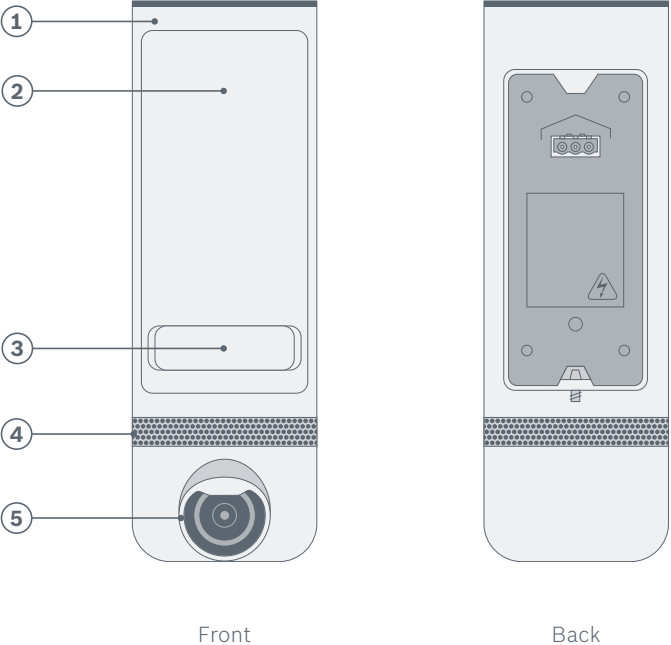

Pos.	Description	Explanation
1	Camera body	–
2	Front light	Automatically switches on when movement is detected in the dark. Can optionally be used as decoration or welcome light
3	Motion detector	180°
4	Speaker mesh	Protects the speaker and microphone
5	Wide angle lens	Covers a horizontal viewing angle of 120 degrees; the direction of view can be optimized during installation

4.0 INDICATORS AND CONTROL

4.1 Product overview

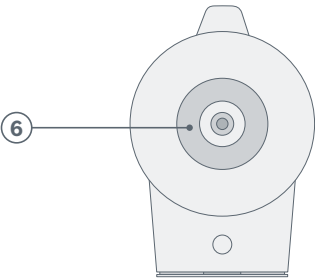

Top

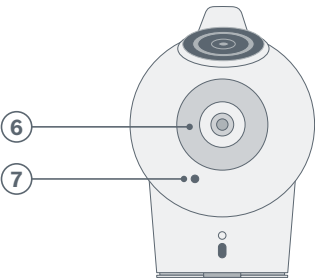

Bottom

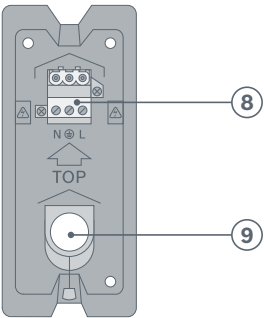

Wall mounting plate

Pos.	Description	Explanation
6	Decorative light	Top and bottom decoration lights
7	Reset hole	Resets all settings in the camera, deletes all stored video, removes the camera from your system
8	Terminal block	Connection for line wire, neutral wire and earth wire
9	Cable entry	Please make sure the 230V power cable is routed through this entry hole

5.0 FIXING

5.1 Fixing instructions



Before you start
Please turn off the electricity at all costs!



You can also watch easy to follow installation videos on our website:
www.bosch-smarthome.com/installation

5.2 Check the Wi-fi availability



The Eyes-Outdoor Camera needs a stable and sufficiently strong Wi-fi connection.



Please choose the location where you would like to position your Eyes-Outdoor Camera and check the strength of the Wi-fi-signal using your smart phone.

3G/4G	✗
	✗
	✗
	✓
	✓

The table above indicates if the Wi-fi connection strength is sufficient for use in combination with the Eyes-Outdoor Camera.

5.3 Install the wall mounting plate



The Eyes-Outdoor Camera needs 230 VAC power supply (line wire, neutral wire and earth wire).



Before you start the installation please ensure the power is switched off at the main power switch.



The Eyes-Outdoor Camera must be installed vertically at a wall between 2.0 and 2.5 meter height above ground.



The Eyes-Outdoor Camera must be installed with the camera at the bottom.

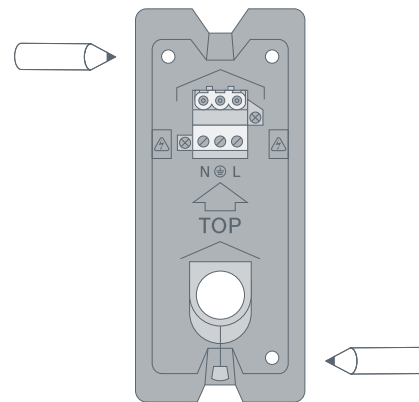

Position the wall mount in the desired location, pull the cable through the cable entry and mark the two screws on the wall through the screw holes.

5.4 Power connection

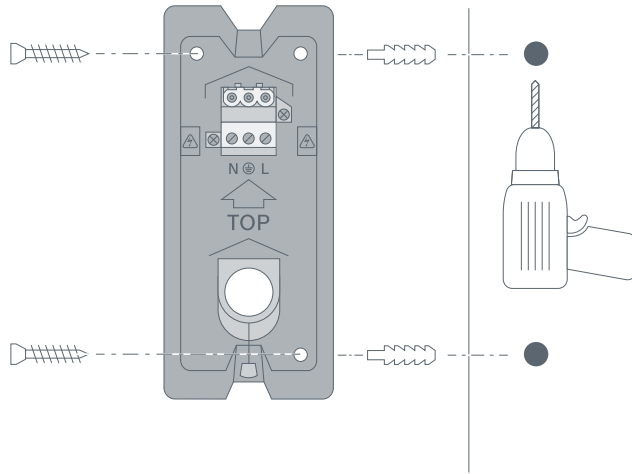

Remove the mounting plate and drill the holes for the plugs. Push in the plugs and fix the mounting plate on the wall with the screws.

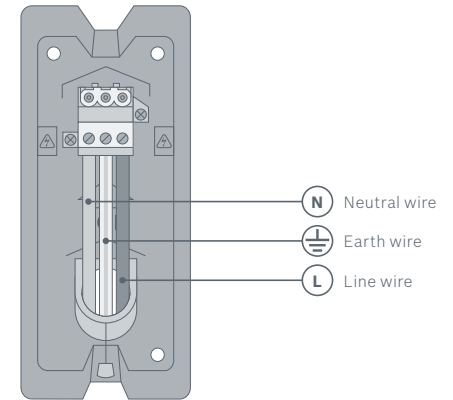

Connect the power wires as indicated.

5.5 Place the Eyes-Outdoor Camera

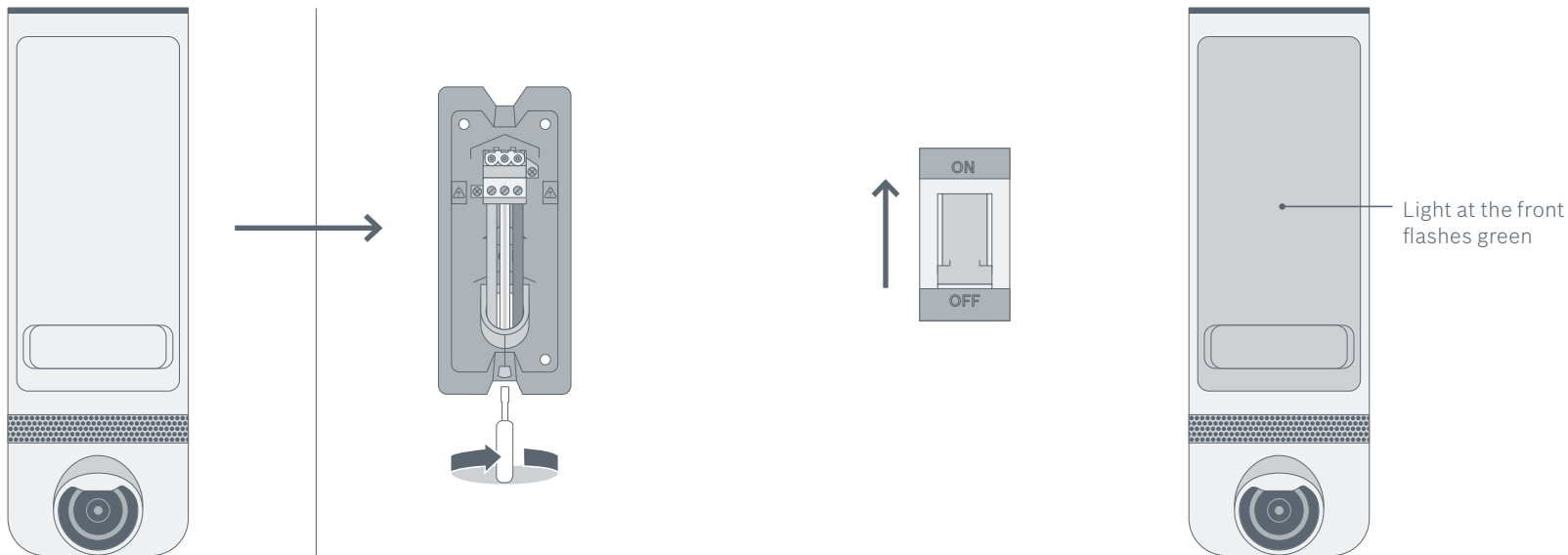

Push the Eyes-Outdoor Camera onto the mounting plate until you hear a click. Lock the camera in place with the locking screw. Please use the screwdriver provided to do so.

You can now switch on the power. The camera now boots. When it is ready for the next installation step, the light at the front flashes green.

6.0 INSTALLATION AND INITIAL CONFIGURATION



Before you start

Please first download the Bosch Smart Camera App. You need the app to install and configure the Eyes-Outdoor Camera. Make sure you have a Wi-Fi internet connection available and the password to hand. Make sure your smart phone is connected to the same Wi-fi network you want to use for the camera.

For Android Devices	Für Apple iOS-Geräte
<ul style="list-style-type: none">▶ Open Google Play▶ Search for "Bosch Smart Home"▶ Select the "Bosch Smart Camera App"▶ Tap "Install"	<ul style="list-style-type: none">▶ Open the App Store▶ Search for "Bosch Smart Home"▶ Select the "Bosch Smart Camera App"▶ Tap "Install"

6.1 Start Camera App



To configure the Eyes-Outdoor Camera you need to make sure your phone is connected to the same Wi-fi network you want to connect the device to. If your router support two frequency bands (2.4 GHz and 5 GHz), select the 2.4 GHz band with your smart phone.



Please don't close or switch the app during commissioning.

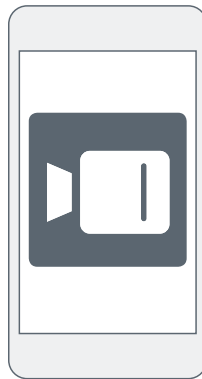

How to set up your Eyes-Outdoor Camera: launch app and log in or register if you do not yet have a Bosch account.

6.2 Configuration of the Eyes-Outdoor Camera

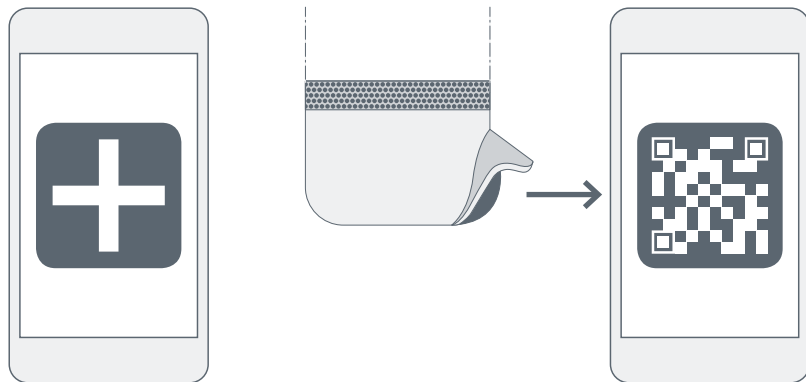

In the Bosch Smart Camera App overview screen, select “Add Camera” and follow the steps indicated in the app.

Once you have completed all the necessary entries, the app generates a QR code. Hold it approx. 10 - 20 cm away from the camera lens.

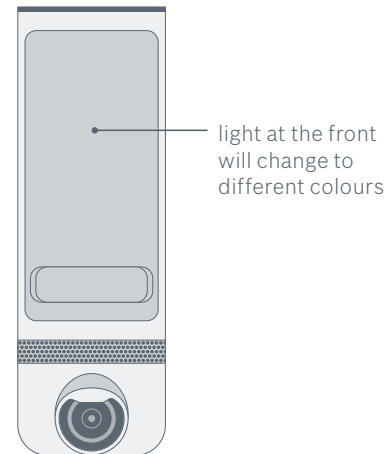

When the Eyes-Outdoor Camera recognized the QR code, you will hear a beep. The camera now begins its initialisation routine during which the top half of the light at the front will change

to different colours. At the end of the routine it will light up blue for approx. 1 min and the camera is displayed in the app. It is now ready for use.

7.0 ERROR AND ERROR RESOLUTIONS

Error	Error indicator	Measure
LED off during installation	LED off	Please check the power supply connection to your camera
Generic boot error	LED blinks red	Switch off mains fuse or remove camera from wall, wait 30 seconds and then power up again
Connection to Wi-fi failed	LED blinks alternating red and green	Check the strength of the Wi-fi signal (on the camera and on your smartphone). Check in your router whether DHCP is active and connecting new devices is allowed (MAC filter address). Tap previous in the app, re-enter the Wi-fi password, create new QR code and show QR code to the camera. If this error is observed with a camera which was previously working normally, check your Wi-Fi router.
Connection to cloud service failed	LED blinks alternating red and blue	Check the internet connection of your router; if OK, wait 30 minutes



More detailed information, like how to reset your camera to factory defaults, visit the online FAQs at www.bosch-smarthome.com/faq

8.0 EYES-OUTDOOR CAMERA OPERATION

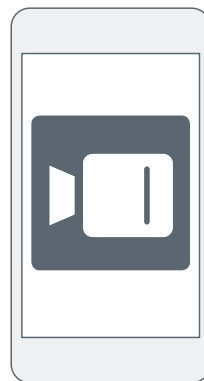

The Eyes-Outdoor Camera is operated and controlled via the Bosch Smart Camera App.

More details on all functionality can be found online in the FAQs section at: www.bosch-smarthome.com/faq

9.0 MAINTENANCE AND CARE

The product is maintenance-free. Repairs should only be performed by qualified persons. Clean the product

with a soft clean dry and lint-free cloth. Do not use cleaning agents containing solvents.



Incorrect handling (see notes on intended use) or non-observance of hazard warnings may compromise the protection afforded by the device.

10.0 PRODUCT DETAILS

10.1 Technical details

Device type name	SVO-1601-220
Resolution	1920 x 1080 (1080p)
Horizontal viewing angle	120°
Vertical viewing angle	79°
Wi-fi	IEEE 802.11b/g/n, 2.4 GHz
Wi-fi free field range	80 m
Max. transmitting capacity	20 dBm
Dimensions (H x W x D)	210 mm x 70 mm x 100 mm
Power Supply	210–250 VAC, 50 Hz
Power consumption	15 W max
Power consumption front illumination	7 W max
Power consumption top/down illumination	each 1 W
Weight	750 g
Operational temperature	-20 °C to +50 °C
Software class	Class A
Dimensions packaging	285 mm x 190 mm x 100 mm
Country of Origin	China

10.2 Declaration of conformity

Hereby, Robert Bosch Smart Home GmbH declares that the radio equipment type Bosch Smart Home Eyes-Outdoor Camera is in compliance with Directive 2014/53/EU.

The full text of the EU declaration of conformity is available at the following internet address:

**[www.bosch-smarthome.com/
EU-declarations-of-conformity](http://www.bosch-smarthome.com/EU-declarations-of-conformity)**



10.3 Faults in radio operation

Faults in radio operation (e.g. due to electric motors or defective electrical devices) cannot be ruled out. The radio range inside buildings may differ greatly from the radio range in free-field conditions. Apart from the

transmission power and the receiver characteristics, environmental influences such as humidity and structural characteristics may also influence radio operation.

10.4 FCC Statement

NOTE: This equipment has been tested and found to comply with the limits for a Class B digital device, pursuant to part 15 of the FCC Rules. These limits are designed to provide reasonable protection against harmful interference in a residential installation. This equipment generates, uses and can radiate radio frequency energy and, if not installed and used in accordance with the instructions, may cause harmful interference to radio communications. However, there is no guarantee that interference will not occur in a particular installation. If this equipment does cause harmful interference to radio or television reception, which can be determined by turning the equipment off and on, the user is encouraged to try to correct the interference by one or more of the following measures:

- ▶ Reorient or relocate the receiving antenna.
- ▶ Increase the separation between the equipment and receiver.
- ▶ Connect the equipment into an outlet on a circuit different from that to which the receiver is connected.
- ▶ Consult the dealer or an experienced radio/TV technician for help.

This device complies with Part 15 of the FCC rules standard. Operation is subject to the following two conditions: **(1)** This device may not cause harmful interference, and **(2)** This device must accept any interference received, including interference that may cause undesired operation.

This device and its antenna(s) must not be co-located or operating in conjunction with any other antenna or transmitter. Changes or modifications to this unit not expressly approved by the party responsible for compliance could void the user authority to operate the equipment. Referring to the multi-transmitter policy, multiple-transmitter(s) and module(s) can be operated simultaneously without C2P. This equipment complies with FCC radiation exposure limits set forth for an uncontrolled environment. This equipment should be installed and operated with minimum distance 20 cm between the radiator and your body.

10.5 Open-Source-Software

This Bosch Smart Home product uses open-source software. You will find the license information for the components used on this site.

Copyright (C) 2009-2013 ARM Limited. All rights reserved. Redistribution and use in source and binary forms, with or without modification, are permitted provided that the following conditions are met:

- ▶ Redistributions of source code must retain the above copyright notice, this list of conditions and the following disclaimer.
- ▶ Redistributions in binary form must reproduce the above copyright notice, this list of conditions and the following disclaimer in the documentation and/or other materials provided with the distribution.
- ▶ Neither the name of ARM nor the names of its contributors may be used to endorse or promote products derived from this software without specific prior written permission.

THIS SOFTWARE IS PROVIDED BY THE COPYRIGHT HOLDERS AND CONTRIBUTORS "AS IS" AND ANY EXPRESS OR IMPLIED WARRANTIES, INCLUDING, BUT NOT LIMITED TO, THE IMPLIED WARRANTIES OF MERCHANTABILITY AND FITNESS FOR A PARTICULAR PURPOSE ARE DISCLAIMED. IN NO EVENT SHALL THE COPYRIGHT OWNER OR CONTRIBUTORS BE LIABLE FOR ANY DIRECT, INDIRECT, INCIDENTAL, SPECIAL, EXEMPLARY, OR CONSEQUENTIAL DAMAGES (INCLUDING, BUT NOT LIMITED TO, PROCUREMENT OF SUBSTITUTE GOODS OR SERVICES; LOSS OF USE, DATA, OR PROFITS; OR BUSINESS INTERRUPTION) HOWEVER CAUSED AND ON ANY THEORY OF LIABILITY, WHETHER IN CONTRACT, STRICT LIABILITY, OR TORT (INCLUDING NEGLIGENCE OR OTHERWISE) ARISING IN ANY WAY OUT OF THE USE OF THIS SOFTWARE, EVEN IF ADVISED OF THE POSSIBILITY OF SUCH DAMAGE.

10.6 Environmental protection and product disposal

Environmental protection and disposal
Electrical and electronic equipment that is no longer usable and defective or used batteries must be separated from other waste and recycled in an environmentally friendly manner (European Directive on waste electrical and electronic equipment).

To dispose of old electrical and electronic equipment or batteries, use your country-specific return and collection systems.



11.0 FURTHER INFORMATIONS

You can find more detailed information on operating and maintaining the Eyes-Outdoor Camera in the online FAQs at

www.bosch-smarthome.com/faq

You will also find all contact details on the rear side of this document.

11.1 Bosch Smart Home System

Save on heating costs, protect your valuables, create mood lighting and much more: Bosch Smart Home offers a complete, intelligent system to make your life more comfortable, safer

and more sustainable. Learn how to integrate your Outdoor Camera in the online FAQs at

www.bosch-smarthome.com/faq



Sale and transfer

Before you transfer or sell your device, delete your personal information. To do this, reset the device to its factory settings (see online FAQs).

#BeSmarter

INTERCONNECTED SMART HOME PRODUCTS

Bosch Smart Home offers a range of products to make your life more comfortable, safer and more sustainable.

More at www.bosch-smarthome.com



 Robert Bosch Smart Home GmbH
Schockenriedstraße 17
D-70565 Stuttgart-Vaihingen

 00800 8437 6278 (free)
Mon–Fri 7:00 am–8:00 pm
Sat 8:00 am–6:00 pm

 service@bosch-smarthome.com



BOSCH